

4251.10m2 rezone area

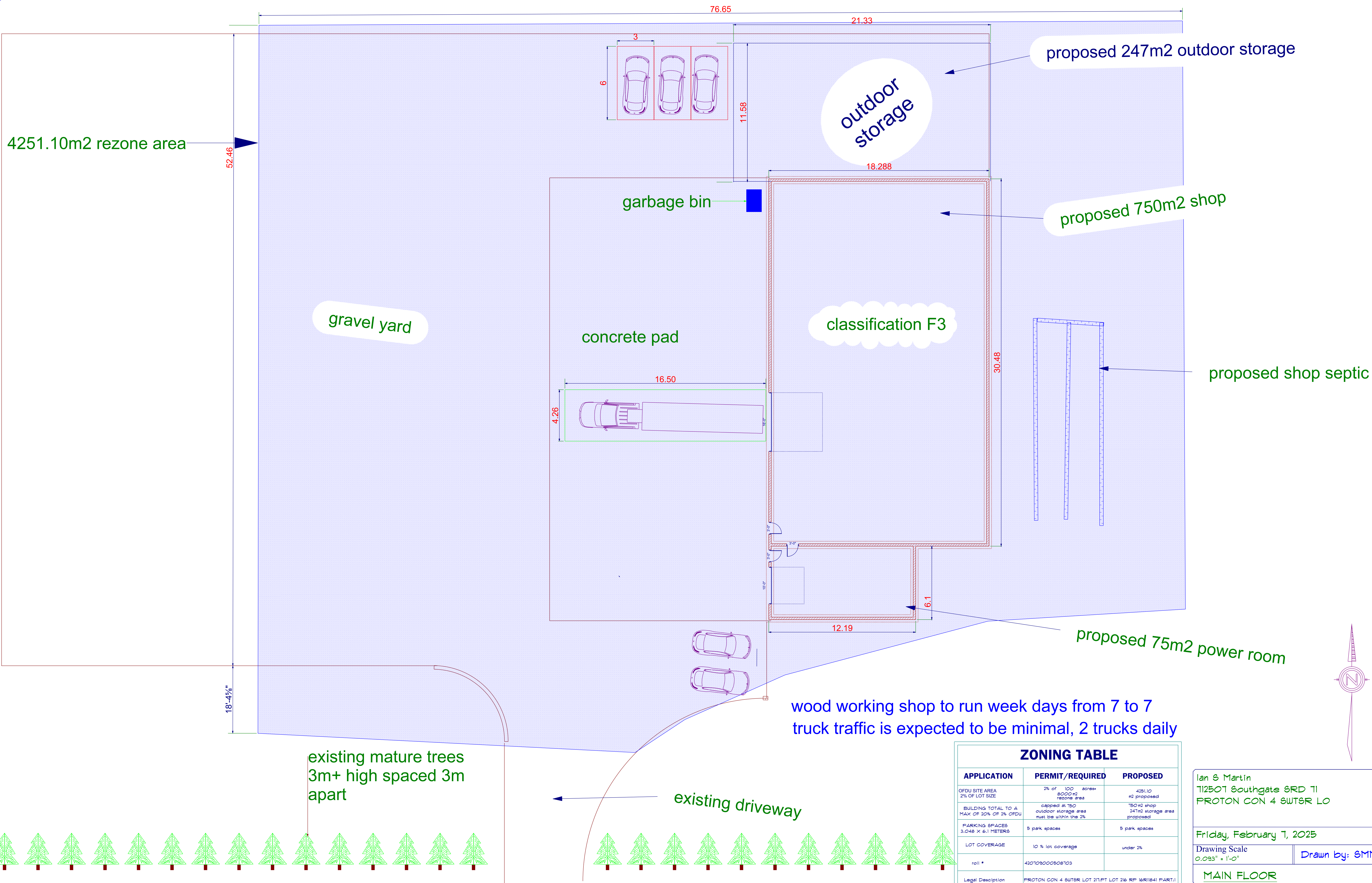

wood working shop to run week days from 7 to 7
truck traffic is expected to be minimal, 2 trucks daily

ZONING TABLE		
APPLICATION	PERMIT/REQUIRED	PROPOSED
OFDU SITE AREA 2% OF LOT SIZE	2% of 100 acres 8000m ² rezone area	4251.10 m ² proposed
BUILDING TOTAL TO A MAX OF 20% OF 2% OFDU	capped at 150 outdoor storage area must be within the 2%	150m ² shop 247m ² storage area proposed
PARKING SPACES 3.048 X 6.1 METERS	5 park spaces	5 park spaces
LOT COVERAGE	10 % lot coverage	under 2%
roll #	420709000508703	
Legal Description	PROTON CON 4 SUTSR LOT 21/PT LOT 21/ RP 16/R11841 PART:1	

Ian S Martin
712507 Southgate SRD 71
PROTON CON 4 SUTSR LO

Friday, February 7, 2025

Drawing Scale
0.033" = 1'-0"

Drawn by: SMM

MAIN FLOOR