

Linwood Industrial Corp.,
280354 Artemesia Southgate Townline
Proton Station ON NOC ILO
519-502-2636
Norman Hoover

DRAWN BY: PHM
SCALE: N.T.S.

S-4 ELEVATIONS

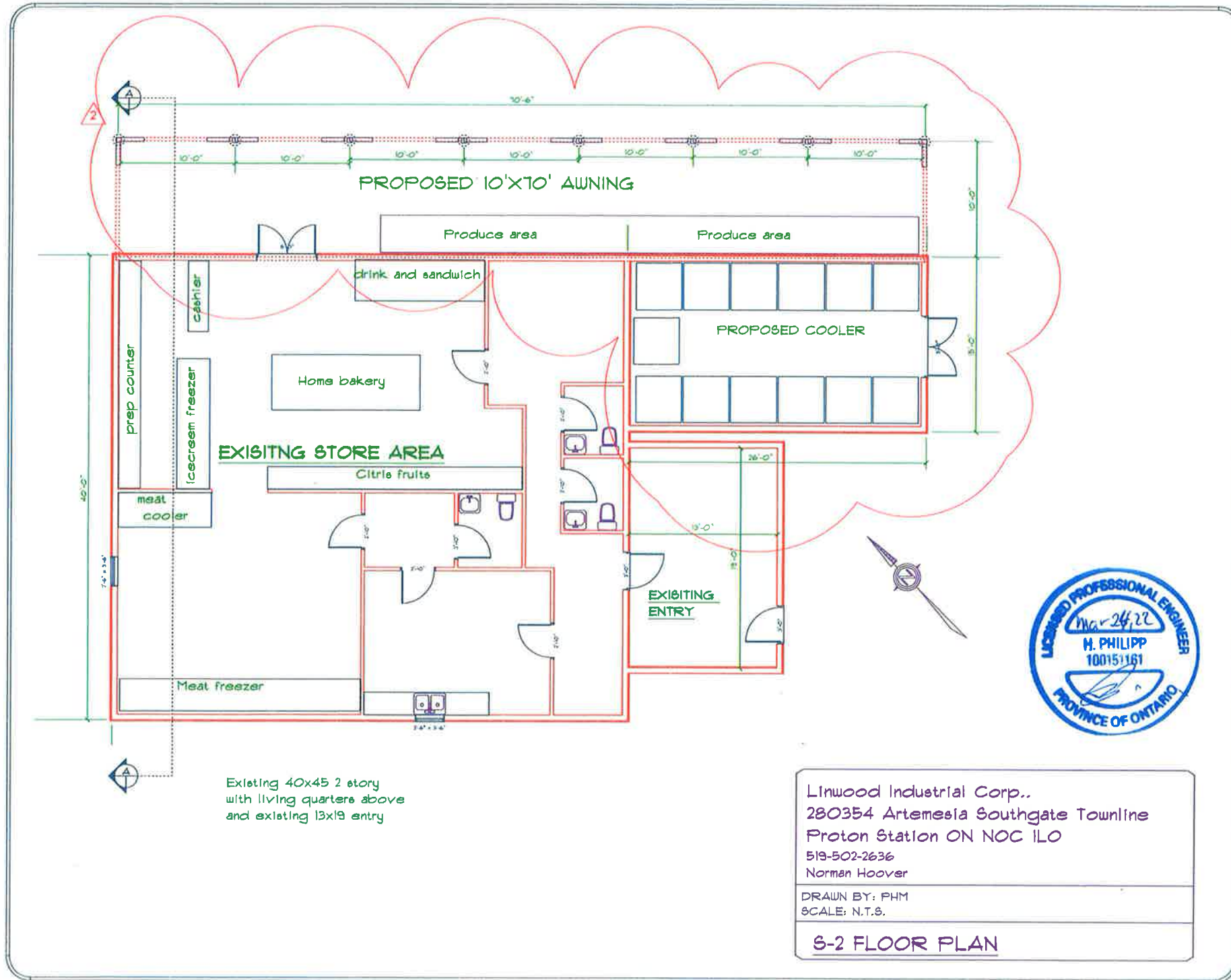

Existing 40x45 2 story
with living quarters above
and existing 13x19 entry

Linwood Industrial Corp.,
280354 Artemesia Southgate Townline
Proton Station ON NOC ILO
519-502-2636
Norman Hoover

DRAWN BY: PHM
SCALE: N.T.S.

S-2 FLOOR PLAN



proposed cooler building

proposed awning

proposed parking

Highway 10

Artemesia-Southgate
Townline

2010
Air Photos 2020